

# ACCESSORIES

## UNIVERSAL Y-CONNECTOR PIPE

Made of aluminized AKDQ expandable material.



41710 - Overall length 12"

## UNIVERSAL Y-CONNECTORS

Made of AKDQ expandable material.

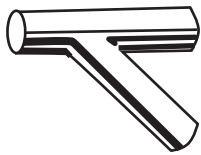

45°

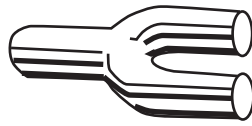

180°



180°

Part No.	Size	Part No.	Size	Part No.	Size
41355	2 1/4" O.D.	41356	1 7/8" O.D.	41357	1 7/8" O.D. x 1 5/8" O.D.

## CHRYSLER HANGER PART NO. 35741

The following illustrations show how to replace the O.E. clamp/hanger on various Chrysler applications.

### Applications:

#### Chrysler

1985 - 1983 New Yorker  
 1984 - 1983 E-Class  
 1985 - 1984 Laser  
 1985 - 1982 LeBaron

#### Dodge

1986 - 1983 600  
 1985 - 1981 Aries-400  
 1985 - 1984 Daytona  
 1985 Lancer  
 1990 - 1981 Omni-024-Charger

#### Plymouth

1985 Caravelle  
 1990 - 1981 Horizon-TC3-Turismo  
 1985 - 1981 Reliant

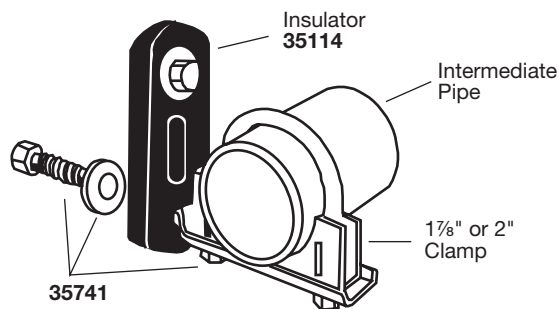
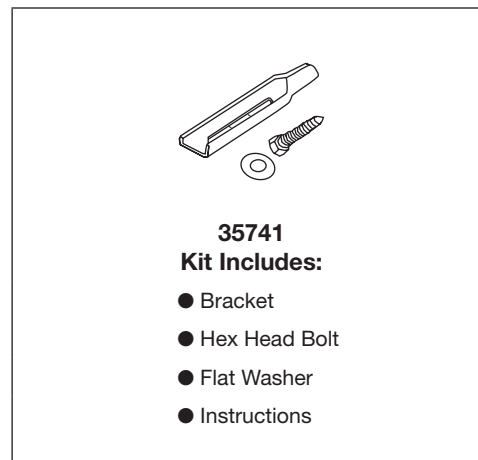

# ACCESSORIES

## CONNECTORS – REDUCERS

### I.D.-I.D. CONNECTOR

Connects O.D. Pipes and/or tubing of the same size.

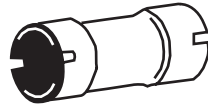

Part No.	I.D. - I.D.	Lgth.
41919	1½-1½	4
41921	1⅝-1⅝	4
41926	1¾-1¾	4
41933	1⅞-1⅞	4
41940	2-2	4
41948	2⅛-2⅛	4
41951	2¼-2¼	4
41957	2½-2½	4
41967	2¾-2¾	4
41812	3-3	4
41892	3-3	6
41893	3½-3½	6
51064	4-4	4
41895	4-4	8
41899	5-5	8
41557	6-6	8

### I.D.-O.D. CONNECTOR

Connects O.D. & I.D. pipes and/or tubing of the same size

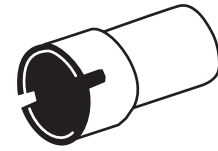

Part No.	I.D. - O.D.	Lgth.
41810	1½-1½	4
41920	1½-1½	12
41882	1¾-1¾	5
41931	1¾-1¾	12
41759	1⅞-1⅞	4
41944	2-2	4½
41902	2-2	10
41947	2-2	12
51126	2⅛-2⅛	4½
41954	2¼-2¼	4½
41956	2¼-2¼	12
41965	2½-2½	4½
41966	2½-2½	12
42596	2½-2½	18
41811	3-3	4
41970	3-3	6
41976	3-3	12
42606	3-3	18
41978	3½-3½	6
41983	3½-3½	12
42127	3½-3½	18
41896	4-4	8
42891	4-4	18
42531	4-4	24
41897	5-5	8
42126	5-5	18
42530	5-5	24
41889	6-6	8

### O.D.-O.D. CONNECTOR

Connects I.D. Pipes and/or tubing of the same size. Also used on manifold outlet.

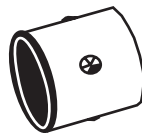

Part No.	O.D. - O.D.	Lgth.
41945	2-2	4½
41964	2½-2½	4½
41971	3-3	6
41979	3½-3½	6
41987	4-4	8
41992	5-5	8

### REDUCING BUSHING

Reduces the I.D. of a muffler inlet or outlet without increasing the muffler overall length.



Part No.	O.D. - I.D.
36275	1½-1⅝
35253†	2-1⅝
35254†	2⅛-2

† Order in Qty. of 6

GENERAL INFORMATION

PASSENGER CAR

LIGHT TRUCK

MUFFLER SPECS.

OPTIONAL MUFFLERS

ACCESSORIES

FOOTNOTES

# ACCESSORIES

## CONNECTORS – REDUCERS

### I.D.-I.D. REDUCER

Reduces O.D. Pipe and/or tubing of different size.

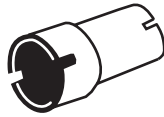

Part No.	I.D. - I.D.	Lgth.
41922	1 $\frac{5}{8}$ -1 $\frac{1}{2}$	4 $\frac{1}{2}$
41927	1 $\frac{3}{4}$ -1 $\frac{1}{2}$	4 $\frac{1}{2}$
41929	1 $\frac{3}{4}$ -1 $\frac{5}{8}$	4 $\frac{1}{2}$
41934	1 $\frac{7}{8}$ -1 $\frac{3}{4}$	4 $\frac{1}{2}$
41886	2-1 $\frac{1}{2}$	4
41941	2-1 $\frac{3}{4}$	4 $\frac{1}{2}$
41943	2-1 $\frac{7}{8}$	4 $\frac{1}{2}$
41952	2 $\frac{1}{4}$ -2	4 $\frac{1}{2}$
41958	2 $\frac{1}{2}$ -2	4 $\frac{1}{2}$
41961	2 $\frac{1}{2}$ -2 $\frac{1}{4}$	4 $\frac{1}{2}$
41973	3-2 $\frac{1}{2}$	6
41687	3-2 $\frac{3}{4}$	6
41981	3 $\frac{1}{2}$ -3	6
41989	4-3	6
41894	4-3 $\frac{1}{2}$	6
41898	5-4	8
41879	5-4 $\frac{1}{2}$	6
41998	6-5	6

### I.D.-O.D. REDUCER

Reduces larger O.D. pipe and/or tubing to smaller I.D. pipe. Also used as muffler bushing or manifold outlet.

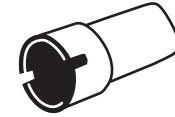

Part No.	I.D. - O.D.	Lgth.
41855	1 $\frac{1}{2}$ -1 $\frac{3}{8}$	4
41923	1 $\frac{5}{8}$ -1 $\frac{1}{2}$	4 $\frac{1}{2}$
41928	1 $\frac{3}{4}$ -1 $\frac{1}{2}$	4 $\frac{1}{2}$
41930	1 $\frac{3}{4}$ -1 $\frac{5}{8}$	4 $\frac{1}{2}$
41932	1 $\frac{7}{8}$ -1 $\frac{3}{4}$	2 $\frac{5}{8}$
41939	2-1 $\frac{3}{4}$	2 $\frac{5}{8}$
41942	2-1 $\frac{7}{8}$	4 $\frac{1}{2}$
41949	2 $\frac{1}{8}$ -2	4 $\frac{1}{2}$
41888	2 $\frac{1}{4}$ -1 $\frac{7}{8}$	4
41955	2 $\frac{1}{4}$ -2	4 $\frac{1}{2}$
41854	2 $\frac{1}{4}$ -2 $\frac{1}{8}$	4
41959	2 $\frac{1}{2}$ -2	4 $\frac{1}{2}$
51065	2 $\frac{1}{2}$ -2 $\frac{21}{32}$	4
41962	2 $\frac{1}{2}$ -2 $\frac{1}{4}$	4 $\frac{1}{2}$
41999	2 $\frac{3}{4}$ -2 $\frac{1}{2}$	8
41974	3-2 $\frac{1}{2}$	6
41982	3 $\frac{1}{2}$ -3	6
41563	4-3	6
41984	4-3 $\frac{1}{2}$	6
41909	5-4	6
41997	6-5	6

### O.D.-O.D. REDUCER

Reduces I.D. pipe and/or tubing of different sizes.

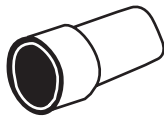

Part No.	O.D. - O.D.	Lgth.
41908	2-1 $\frac{7}{8}$	5 $\frac{1}{4}$
41937	2-1 $\frac{13}{16}$	4 $\frac{1}{2}$
41700	2 $\frac{1}{4}$ -2	4 $\frac{1}{2}$
41917	2 $\frac{1}{2}$ -2	4 $\frac{1}{2}$
41918	2 $\frac{1}{2}$ -2 $\frac{1}{4}$	4 $\frac{1}{2}$
41890	4-3	8
41891	5-4	8
41845	5-4 $\frac{1}{2}$	6
41844	6-4	6
41515	6-5	8

### O.D.-I.D. REDUCER

Reduces larger I.D. pipe and/or tubing to smaller O.D. pipe. Also used as muffler bushing or manifold outlet.



Part No.	O.D. - I.D.	Lgth.
41883	1 $\frac{1}{2}$ -1 $\frac{3}{8}$	4
41924	1 $\frac{5}{8}$ -1 $\frac{1}{2}$	4 $\frac{1}{2}$
41925	1 $\frac{3}{4}$ -1 $\frac{5}{8}$	2 $\frac{5}{8}$
41885	1 $\frac{7}{8}$ -1 $\frac{1}{2}$	4 $\frac{1}{2}$
41935	1 $\frac{7}{8}$ -1 $\frac{3}{4}$	4 $\frac{1}{2}$
41946	2-1 $\frac{3}{4}$	5 $\frac{3}{8}$
51127	2-1 $\frac{7}{8}$	4 $\frac{1}{2}$
41950	2 $\frac{1}{8}$ -2	4 $\frac{1}{2}$
41400	2 $\frac{1}{4}$ -1 $\frac{3}{4}$	4 $\frac{1}{2}$
41953	2 $\frac{1}{4}$ -2	4 $\frac{1}{2}$
41960	2 $\frac{1}{2}$ -2	4 $\frac{1}{2}$
41963	2 $\frac{1}{2}$ -2 $\frac{1}{4}$	4 $\frac{1}{2}$
41968	2 $\frac{3}{4}$ -2 $\frac{1}{2}$	4 $\frac{1}{2}$
41972	3-2 $\frac{1}{2}$	6
41975	3-2 $\frac{3}{4}$	6
41980	3 $\frac{1}{2}$ -3	6
41988	4-3	6
41991	4-3 $\frac{1}{2}$	6
41994	5-4	6
41786	5-4 $\frac{1}{2}$	6
41514	6-5	8

# ACCESSORIES

## EXTENSION PIPES, RESONATOR SUB PIPES, TAIL SPOUTS

Product Description	1½" Dia.	1⅝" Dia.	1¾" Dia.	1⅞" Dia.	2" Dia.	2⅛" Dia.	2¼" Dia.	2½" Dia.
Extension Pipe ID-OD 12" OAL	41920	—	41931	—	41947	—	41956	41966
Extension Pipe ID-OD 18" OAL	—	—	—	52003	52004	—	52005	42596
Extension Pipe ID-OD 26" OAL	52007	—	52008	52009	52010	52013	52011	52012
Sub Pipe ID-ID 18" OAL	—	—	—	—	52014	—	52015	52016
Tail Spout ID One End 12" OAL	41784	—	41807	—	42536	41808	52018	41809

## ADAPTERS

8" Overall Length with Inlet Flange

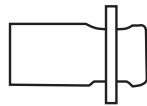
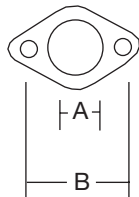

Male Ball

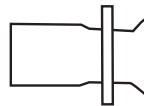

Female Ball

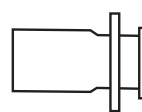

Flat Ball

A	B	Male Ball	Female Ball	Flat Ball
2"	3⅞"	—	41724	41727
2¼"	4¼"	41722	41725	—
2½"	4¼"	41723	41726	—

## EXHAUST REPAIR KIT

18" Galvanized Flex Tubing with Clamp

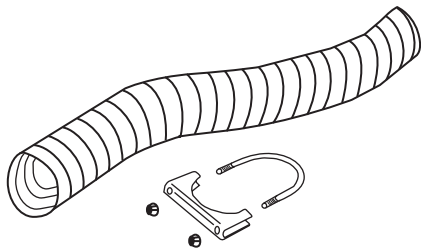

PART NO.	I.D.
36319	1½
36320	1¾
36321	1⅞
36322	2
36323	2⅛
36324	2¼
36325	2⅜
36326	2½
36541	3